



T-L Irrigation Company

INSTALLATION SHEET

**CD91151 INSTALLATION SHEET FOR:
MP89865 END TOWER PRESSURE SWITCH KIT
(Used in conjunction with AgSense Field Commander FC3: TL Solar)
AgSense Phone Number: 605-352-8350**

Parts included in the MP89865 kit:

| Ref. | Part No. | Description | Req'd. |
|------|----------|-----------------------------------|--------|
| 1 | CD91151 | Installation Sheet..... | 1 |
| 2 | FC4893 | Hose Clamp #104 (not shown) | 2 |
| 3 | PT8164 | Tee 1/4" Plated C3709 x 4 | 1 |
| 4 | TC9613 | Tb. Conn. 1/2"ERM x 1/4"NPT..... | 2 |
| 5 | TN9604 | Tb. Nut 1/2"ERM 7105 | 2 |
| 6 | TS9608 | Tb. Sleeve 1/2"ERM 7165 x 8..... | 2 |

Shipped separate:
ES52613 Pressure Switch 800 psi (normally closed)..... 1

Installation of Hydraulic Pressure Switch:

Cut into 1/2" Pressure Line in any one of three locations. (Make sure switch cable is long enough to reach.)

- A. 1/2" Pressure Line to End Gun Cylinder if option is on system.
- B. 1/2" Pressure Line at Tower.
- C. 1/2" Pressure Line at Base.

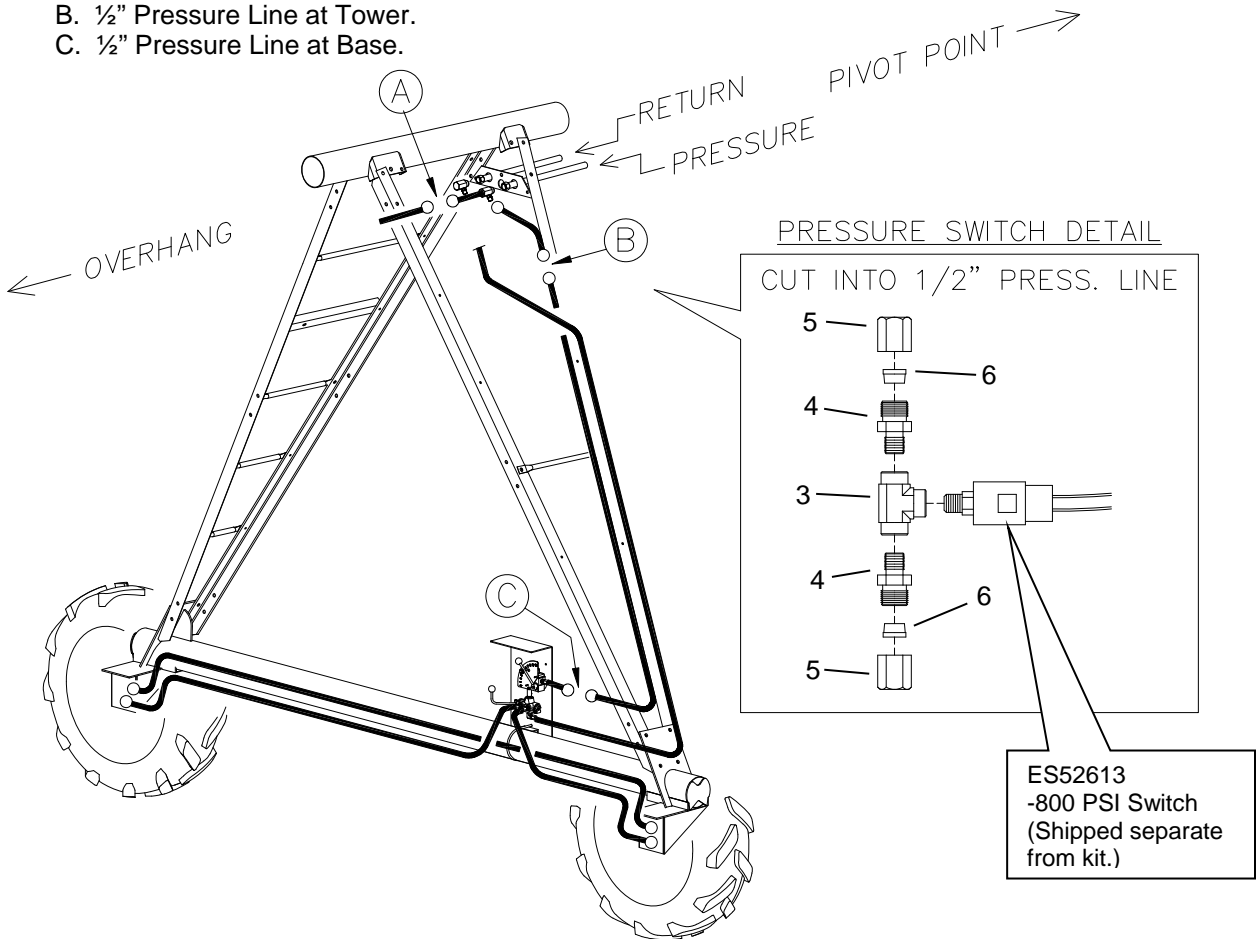



T-L Irrigation Company

INSTALLATION SHEET

Installation

The AgSense unit is installed at the end tower, with mounting in one of two ways.

1. Mounted to the spreader rail on truss rod overhangs with the beam clamps supplied by AgSense as shown in the picture below.



2. Mounted on the span pipe with the hose clamps (FC4893) supplied in the installation kit as shown in the pictures below.

